

PRIVATE ENTRIES

Gerald & Hazel Atherton **Outside**
52 key J.M.Glorie Belgian street organ.

Julian Beel
Twin cylinder textile mill engine, 1/16th scale.

Norris Bomford Stand 132
P40 Stirling engine for automotive use.

Mike Burgum Stand 231
1/35 scale D-Day landings diorama, Landing craft ferry utility @ 1/24 scale, Castle class Corvette 1/76 scale, LCT Mk4; Mk5 & Mk6 1/35 scale radio controlled with vehicles and figures, Landing craft infantry LC1 medium, Landing craft mechanised (3) 1/16 scale with Sherman tank and Willis Jeep.

Neil Carney Single cylinder Mill engine with Corliss valve gear.

Mike Casey Merryweather Gem horse drawn steam fire engine.

Derek Collin Junior 60 Keilkraft aircraft, radio controlled 5ft. Wingspan with Saito 30 4 stroke engine.

Bob Danton Outside
4" Foster traction engine and passenger trolley.

Andy Deacon Stand 213 Radio controlled: Concord, 2.5m long; 15cc Nitro powered Bell Helicopter; giant paper aeroplane, 2.4m long; 3D printer RepRapPro Fisher Delta.

C. J. Eatherton Stand 231 Twin cylinder steamship engine HMS Gorgon, Stuart Beam engine & regulator, Fairburn Column engine 1850, tin plate Landaulette 'covered clockwork car' converted to steam, 1st rate ship of the line 'MDF Hernia'.

D. Everett Stand 121 1/3 scale 'Baker Monitor engine; 1/5 scale Hubbard 2 stroke marine engine, 'Pioneer' Loyale Cycle 2 stroke engine, 1/4 scale pump jack.

Steve Forge 2" Clayton Steam Wagon under type, 2" Clayton radio controlled flat bed wagon, 3/2" gauge Derby 4F steam locomotive, Hot Air Engine, Robinson, as featured in Model Engineer; 10cc water cooled single cylinder four stroke Matador engine, 15cc four cylinder 4 stroke OHC air cooled engine, Small freelance metal turning lathe, Clyde Puffer, LESRO power boat, Arrow.

Ian Glasspool Metropolitan—Vickers electric locomotive (Sherlock Holmes) c.1921 with Jubilee coach and interior, G1.

Derek Goddard Armstrong water hydraulic winding engine c.1848.

Geoff Goodchild Stand 206 Gold Medal Winner—1:14 scale Kittoe and Brotherhood Beam Engine. Just for fun internal combustion engine, Retilliner vertical steam engine. 3/4 size hot air engine of Rev. Stirling's 1826 Air Engine.

Derek Hill Stand 121A
6x6 Merc Truck/car, scratch built trailer including boat. 3D printer kit & box.

Jack Hill Stand 121A
Land Rover Defender 110, Land Rover Defender 110 Pickup, Toyota Hilux Pickup, Man Kat 1 8x8 & 6x6 trailer, Challenger 2 (Megatron).

Ross Hopkins Outside
4" scale Mc.Laren Road locomotive

Dave James Stand 121B
4mm scale Funfair from wood and cardboard.

Graham Jones Brixham Torbay Severn class lifeboat, Ayton Cross Tug.

Kim Kemp Stand 142
A Congreve and a Seaclock

George King Stand 143 Wooden models of: 'Minnie' traction engine, 'Burrell' 5T compound showmans traction engine, French Horn & a pocket trumpet.

Sarah & John Knapp Outside
52 Key Verbeeck Fair Ground Organ imported from Belgium in 1985 after being built by Johnny Verbeeck.

Hywel Lambert Stand 141 Perpetual Calendar clock, small Tower clock movement, detached Gravity Wall clock, French Large Wheel clock, Grasshopper Skeleton clock, St. Pauls Cathedral clock.

Geoffrey Lewis Stand 220 1940/50's mechanical shovel based on the Lima & Marion manufacturer.

Hall 3 & Lecture Room

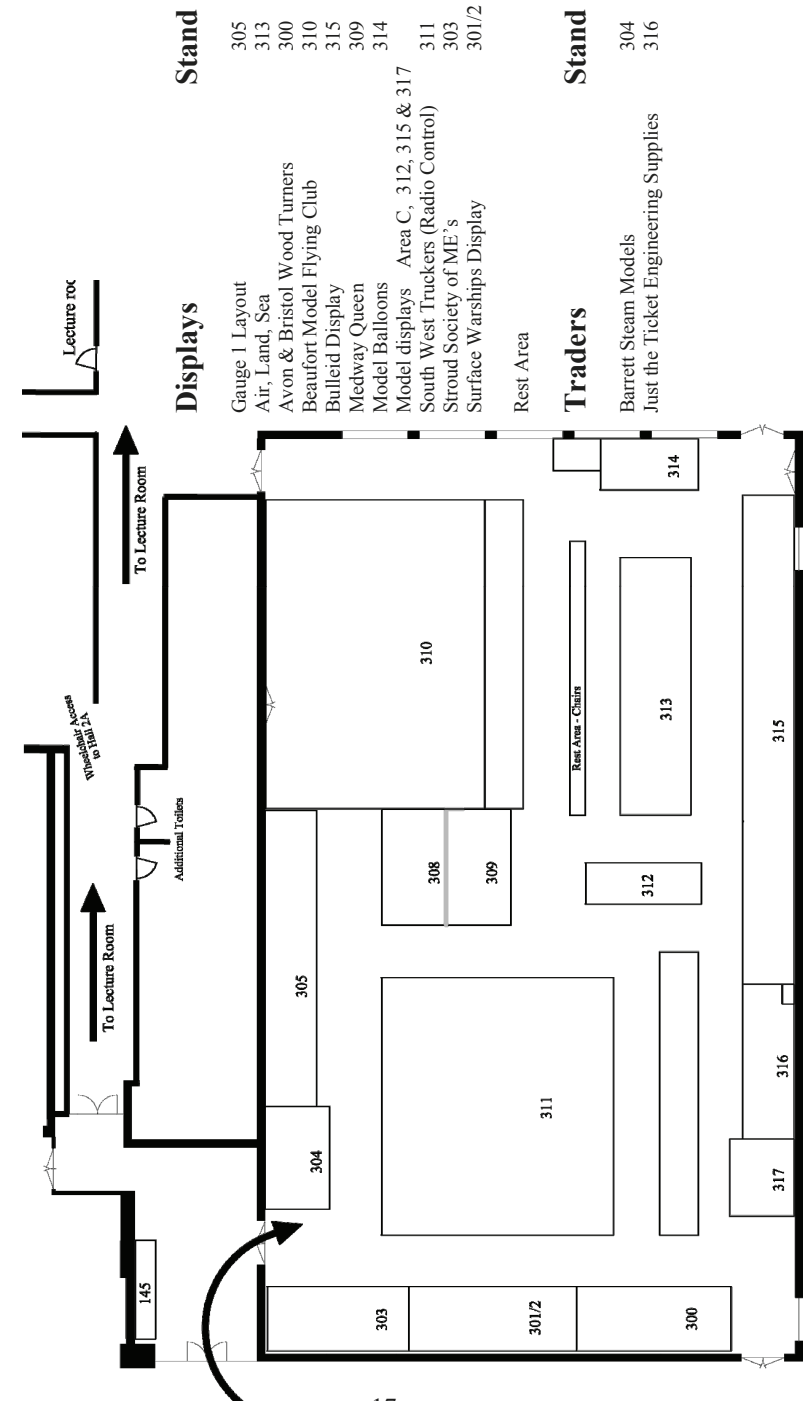

Displays

Association of Model Barge Owners
Bristol Model Car Club
CAEN Model Club
Clevedon & District Model Boat Club
Festiniog Railway Society
Hereford Society MES
5" g Ground Level Society

Stand

204
232
229
223
207
227
218

Displays

Northern Association of ME's
Salisbury & District MES
Severn Mendip 16mm Group
Society of Model & Experimental Eng.
South West Meccano Club
The Stirling Engine Society
UK Train Sim
Model Display Areas A, 213, 220, 231 & 252-255

Cont.

211
203
236
228
225
222
250/1

Halls 2 & 2A

Traders

Antics Models and Hobbies
Blackgates Engineering
Camden Books
EM5-1
Hafix Industrial Products
Home & Workshop Machinery
J.B. Cutting Tools
J. Jeffery
Kontax Engineering
Lee Hammond
M.J. Engineering
Model Engineers Laser
Noggins End Metals
PNP Railways
Polly Model Engineering
SHG Model Supplies
Tools 2000
Turbo Trade
View Models

Stand

217
235
215
216
233
219
212
202
200
210
208
226
205
234
201
221
214
230
209

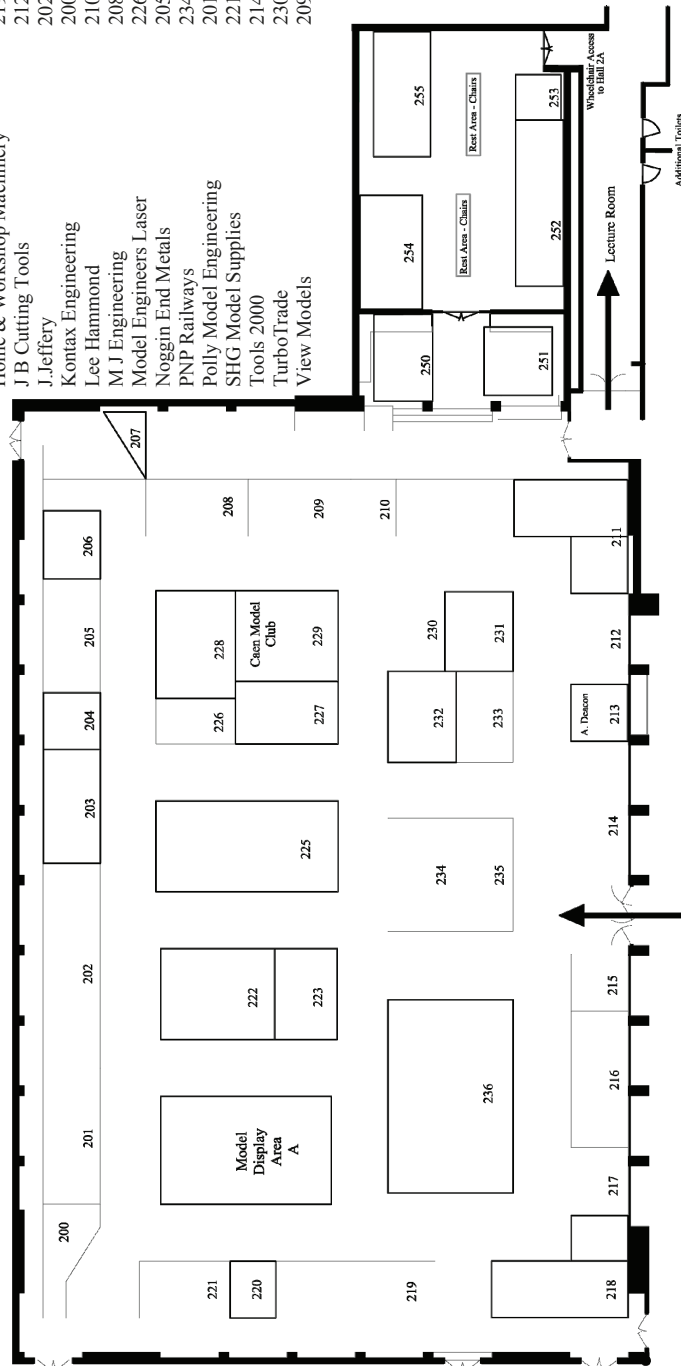

PRIVATE ENTRIES—continued

Richard Lunn Sweet Pea 5" g loco & tender.

Brian Luxford

LBSC built 0-6-0 LMS 4F tender engine 2½" g,
'Annabel' US style Mallet refurbished by LBSC 2½" g,
5" g LBSC design Pansy 0-6-0 GWR Pannier tank.

Jeremy Mills

4.1/2" Plastow Burrell Agricultural engine.

Roger Pitt

Amanco water cooled 2.1/4HP, Petter Apple Top
1.1/2HP

William Powell 2.1/2" g LBSC Ayesha painted in
Marsh umber LBSC livery.

Chris Rayward—Display Area A 3/16" scale
plank broad & butter build coastal freighter, 5" g LNWR
0-6-0 coal engine chassis, both under construction.

B. Richings Collection of 'Mamod' steam engines,
rollers, wagons and associated attachments.

Terence Seago

Westinghouse/Rose-bery 'Farmers' Barn petrol 60cc
working engine; RLE 40cc farmers petrol working Barn
petrol enging.

Reuben Smith

2" scale 2 furrow riding plough,
Cockshot 2 furrow riding plough, Oliver 2 furrow
general purpose plough, Ransoms Sims & Jefferies 2
furrow high cut match Plough, Lister Cockshutt 4 furrow
plough, Saunderson & Mills 2 furrow plough.

Jack Snary Stand 252 A display of
approximately 600 ships covering 5000 years of history
at 1/1200 scale.

Barrie Stevens Stand 317 Collection of
wooden models



Rebecca Strong Stand 255 Display
showing the history of Hornby models in 7mm scale.

Steve Trower **Outside**
4" scale Burrell DCC Road Engine

Maurice Turnbull Nut Cutting Machine,
Archibold Milnes Glasgow c.1840; Cylinder boring
machine 1/12th. Scale by Joshua Buckton Leeds c.1840;
Plate bending machine by Rupert Napier; Angle rolls
c.1890; Deal Sawing machine by John Mc.Dowall,
Johnstone Scotland c.1840; Slotting machine 1/12 scale
by Laird & Co. Greenock c.1830; self-acting compound
planning machine, 1830; combined punching, shearing &
angle cutting machine, 1880.

David Trotham Stand 254 Display showing
the history of Hornby Doublo models in 4mm scale.

Neil Cooke Various 1/24 scale Truck models.

Dick Smith 1/35th scale resin military & ex military
heavy haul age vehicle.

André Ward 1/24 scale AEC Mutant; Bedford KM
Skip lorry.

The above three names represent the **International
Plastic Modellers Society** & are on **Stand 312**

Stephen Wessel ENV Type F aero engine, half
size; Armstrong Siddeley Lynx 4 aero engine 1/3 scale.

Ashley Wootton Collection of 'Mamod' steam
engines, rollers, wagons and associated attachments.

Gerard York 1/4" scale Hawker Tomtit biplane
laser 100 4 stroke engine with 4 channel radio control;
free flight model aircraft (vintage). Rubber powered free
flight aircraft, 1964 free flight glider, electric powered 4
channel radio controlled aerobatic aircraft.



Images from
the exhibition
2016

OUTSIDE

Please take the time to visit the outside attractions. Many of our supporters like to show their models working and the large area is given over to displays of Traction Engines, full size farm IC stationary Engines, the Boating Pond. Many of the Traction Engines will be giving free rides around the Car Park during the Exhibition.

There will also be two full size organs and of course the Gas Turbine Association displays.

Outside Displays

Stationary Engine Enthusiasts
Organs, Gas Turbines.

Demonstrations & Activities

Boating Pool
IC Engine Display Area
Gas Turbine Assoc. displays
Steam Traction & Transport

Outside

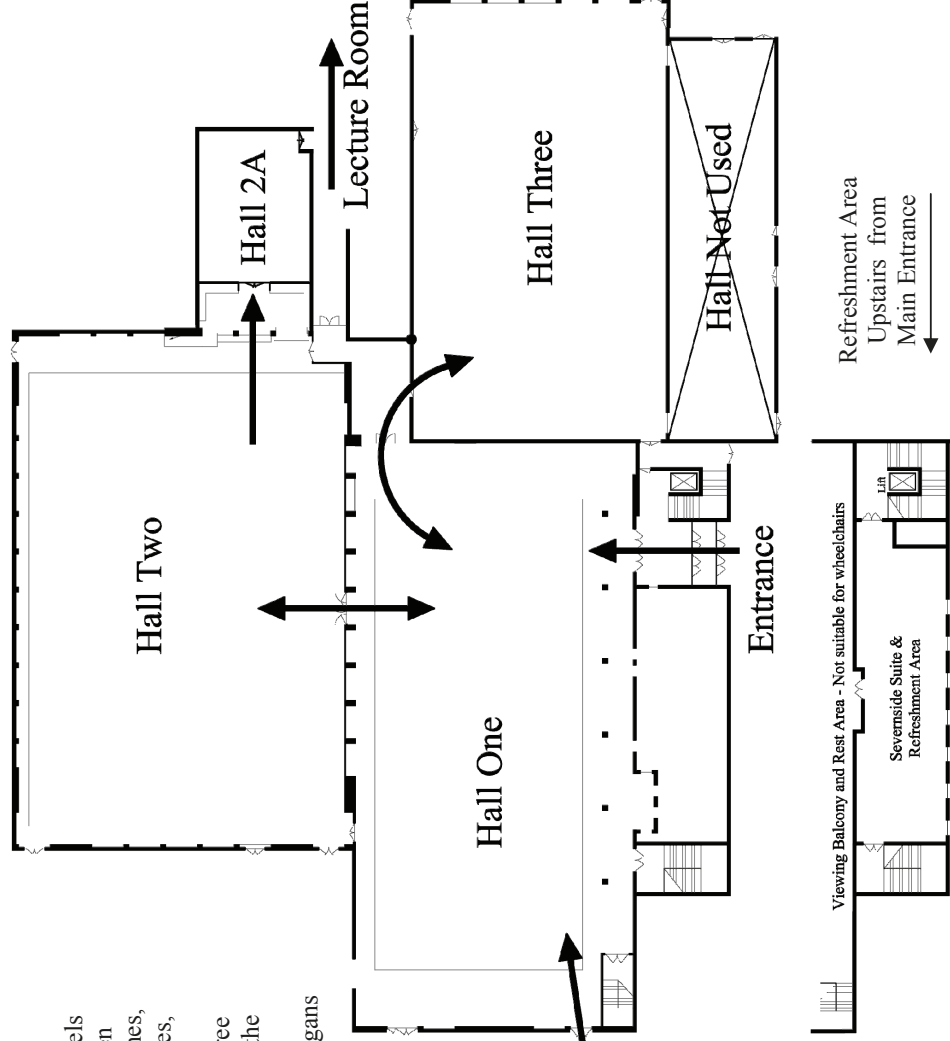

BRISTOL MODEL ENGINEERING & HOBBIES EXHIBITION

Hall 1

Traders
Allendale Electronics Ltd.
College Engineering Supply
CuP Alloys (Modelling) Ltd.
Envio Engineering
HJH Tooling
Peak Tools
R.N.R. Aluminium
Tracy Tools
Western Steam & GS Supplies

Stand Displays
103 2½" Gauge Society
125 6880 Belfon Grange Society
105 Avon Valley Railway
134 Bristol LMS Group
122 Bristol Society MEE
130 Cardiff Marine Modellers
128 Clock Displays
104 Crofton Pumping Skaton
115 East Somerset MEE
Gas Turbine Association
IC Engine Builders Group
Kingsmoor Black 5
Model Display Area

Stand
131
109
108
100
137
101
141 & 142
140
127
124
118 & 120
111
126

Displays—Cont.
Newcomen Society
OLCO
Rolls Royce Heritage Trust
Southern Federation of Model Clubs
Swindon Railway Museum
Taunton Model Engineers
The Guild of Model Wheelwrights
The Society of Ornamental Turners
West Huntspill Model Engineers
Westland & Yeovil District MES
Weston, Clevedon & Portishead
West Wiltshire MES
Woodspring Model Sailing Club

Stand
112
138/9
107
102
119
133
106
113
116
114
144
110
123

